

**RIGHT ANGLE PLUG CRIMP TYPE**

**R187.700.200**

**CABLE 6/50 D**

Series : 7/16  
**COMPOSITE**

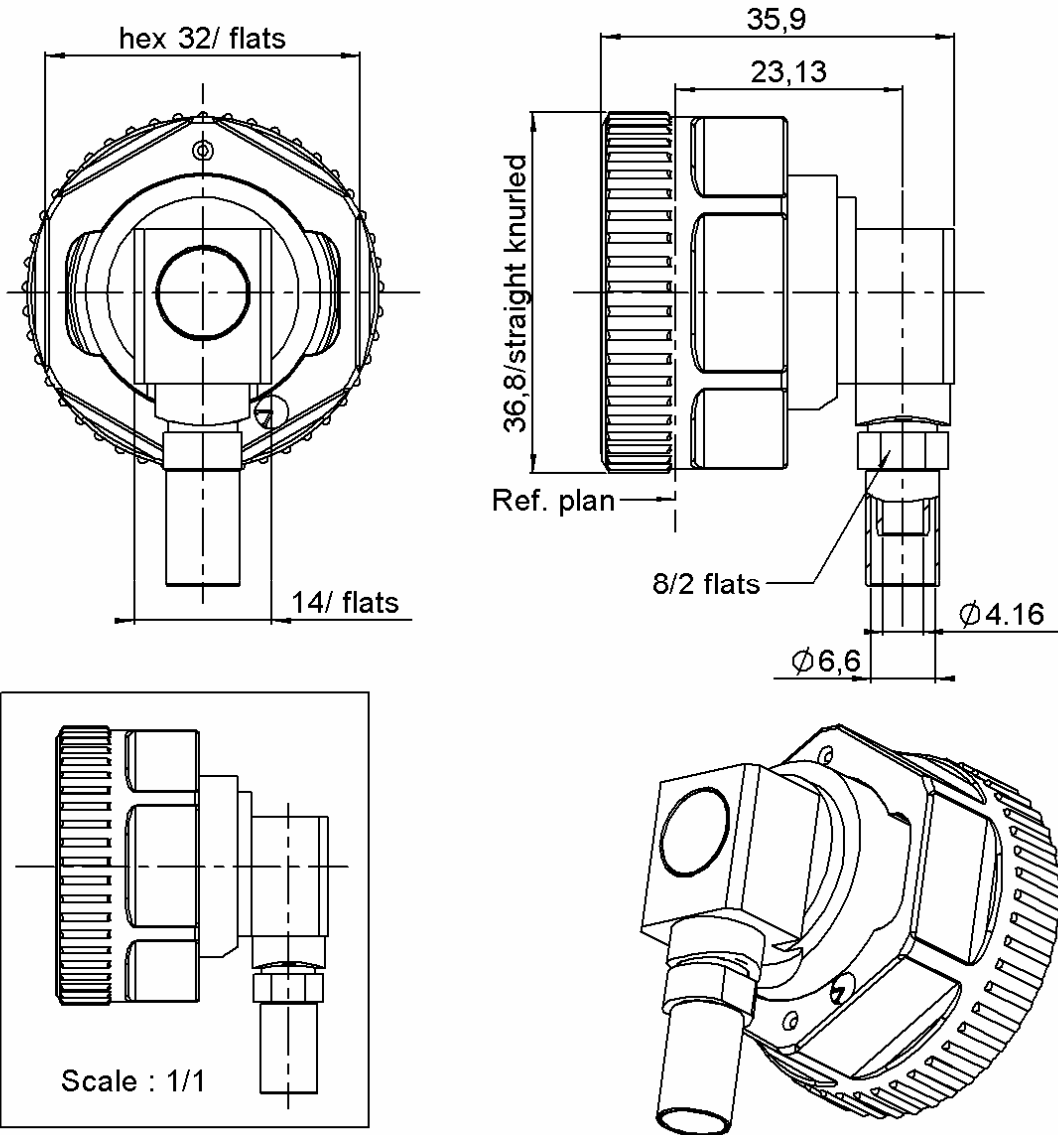

All dimensions are in mm.

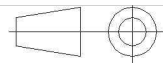

COMPONENTS	MATERIALS	PLATING (µm)
BODY	BRASS	BBR 0.5 OVER SILVER 3
CENTER CONTACT	BRASS	SILVER 5 OVER COPPER 0.5
OUTER CONTACT	BRASS	BBR 0.5 OVER SILVER 3
INSULATOR	PTFE	
GASKET	SILICONE RUBBER	
OTHERS PARTS	COMPOSITE MATERIAL - BLACK	
-	-	-
-	-	-

Issue : 0942 A

In the effort to improve our products, we reserve the right to make changes judged to be necessary.



**RIGHT ANGLE PLUG CRIMP TYPE**

**R187.700.200**

**CABLE 6/50 D**

Series : 7/16  
**COMPOSITE**

**PACKAGING**

Standard	Unit	Other
<b>20</b>	<b>'W' option</b>	<b>Contact us</b>

**SPECIFICATION**

**ELECTRICAL CHARACTERISTICS**

Impedance	<b>50</b>	$\Omega$
Frequency	<b>0-7.5</b>	GHz
VSWR	<b>* + 0,0000</b>	x F(GHz) Maxi
Insertion loss	<b>0.05</b>	$\sqrt{F}$ (GHz) dB Maxi
RF leakage	<b>- ( NA</b>	- F(GHz)) dB Maxi
Voltage rating	<b>500</b>	Veff Maxi
Dielectric withstanding voltage	<b>1500</b>	Veff mini
Insulation resistance	<b>10000</b>	M $\Omega$ mini

**CABLE ASSEMBLY**

Stripping	a	b	c	d	e	f
mm	10,9	6,80	27,5	0,00	16,6	0,00

Assembly instruction : **Crimp 05**

Recommended cable(s)  
ECO 230

Characteristics indicated on this data sheet are those that can be achieved with the highest performance cable. Intrinsic limitations of the cable may diminish the performance of the assembly

Cable retention

- pull off **220** N mini
- torque **NA** N.cm

**MECHANICAL CHARACTERISTICS**

Center contact retention		
Axial force – Mating end	<b>200</b>	N mini
Axial force – Opposite end	<b>100</b>	N mini
Torque	<b>NA</b>	N.cm mini

**TOOLING**

Part Number	Description	Hexagon
.	.	.
<b>R282.223.000</b>	<b>CRIMPING TOOL</b>	<b>6.48</b>
<b>R282.235.013</b>	<b>CRIMPING DIES</b>	<b>6.48</b>
<b>R282.293.000</b>	<b>CRIMPING TOOL</b> M22520/5-01	

Recommended torque		
Mating	<b>2000</b>	N.cm
Panel nut		N.cm
Clamp nut	<b>220</b>	N.cm
A/F clamp nut	<b>8,0000</b>	mm

Mating life(with composite)	<b>50</b>	Cycles mini
Mating life(with brass)	<b>100</b>	Cycles mini
Weight	<b>80,6100</b>	g

**OTHER CHARACTERISTICS**

- \*VSWR:1.15 between DC to 3GHz
- \*VSWR: 1.40 between 3 to 6GHz
- \*\*PIM3 : -90dBm (2 carries of +43dB)
- Interface ingress protection : IP67

**ENVIRONMENTAL**

Operating temperature	<b>-40/+85</b>	$^{\circ}$ C
Hermetic seal	<b>NA</b>	Atm.cm3/s
Panel leakage	<b>NA</b>	

Issue : 0942 A

In the effort to improve our products, we reserve the right to make changes judged to be necessary.



**RIGHT ANGLE PLUG CRIMP TYPE**

**R187.700.200**

Series : 7/16  
COMPOSITE

**CABLE 6/50 D**

**COMPONENTS**

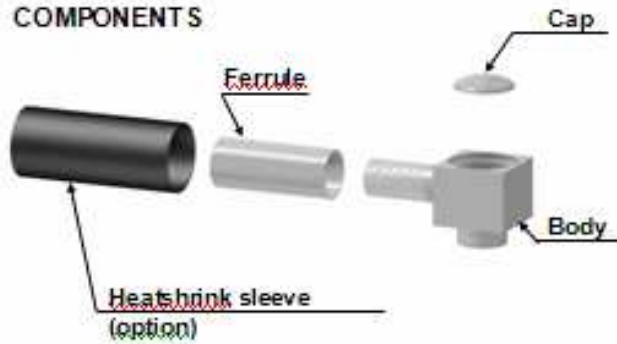

**STRIPPING DIMENSIONS**

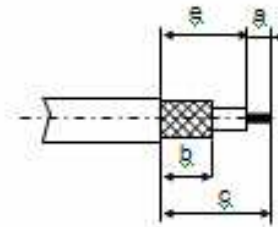

**1**

Slide the heatshrink sleeve onto the cable (Option).  
Slide the ferrule onto the cable.  
Strip the cable.



**4**

Crimp the ferrule with crimping tool (see connector TDS).  
Solder the inner conductor.

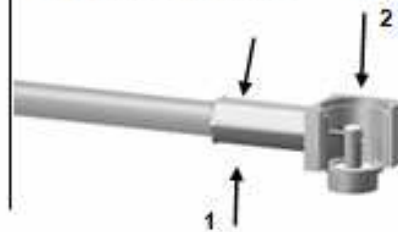

**2**

Fan the braid.



**5**

Place the cap into the body.



**3**

Push the connector body under the braid.  
Slide the ferrule over the braid.

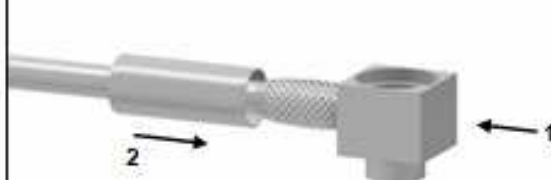

**6**

Press on the cap flush or slightly below the surface of the body assembly.  
Slide the sleeve over the ferrule and heatshrink it in place (Option).



Issue : 0942 A

In the effort to improve our products, we reserve the right to make changes judged to be necessary.

